

John Jacobs, Justin Matticx, Mitchell Rosburg, Christopher Weldon

Homewood Golf Course Clubhouse Design

City of Ames Parks & Recreation Department, Ames, Iowa



Problem Statement

- Inefficient patron flow
- Inefficient employee flow
- Inefficient product flow
- Physiological and physical barriers

Objectives

- Create multiple efficient facility layout plans
- Decrease both physical and physiological barriers

Methods

- Coursework Applied
 - TSM 444 (Facility Planning)
 - TSM 440 (Lean Manufacturing)
 - TSM 216 (Advanced CAD Topics)
 - ABE 273 (2-D AutoCAD Application)

Current Facility Photo



Current Facility Layout

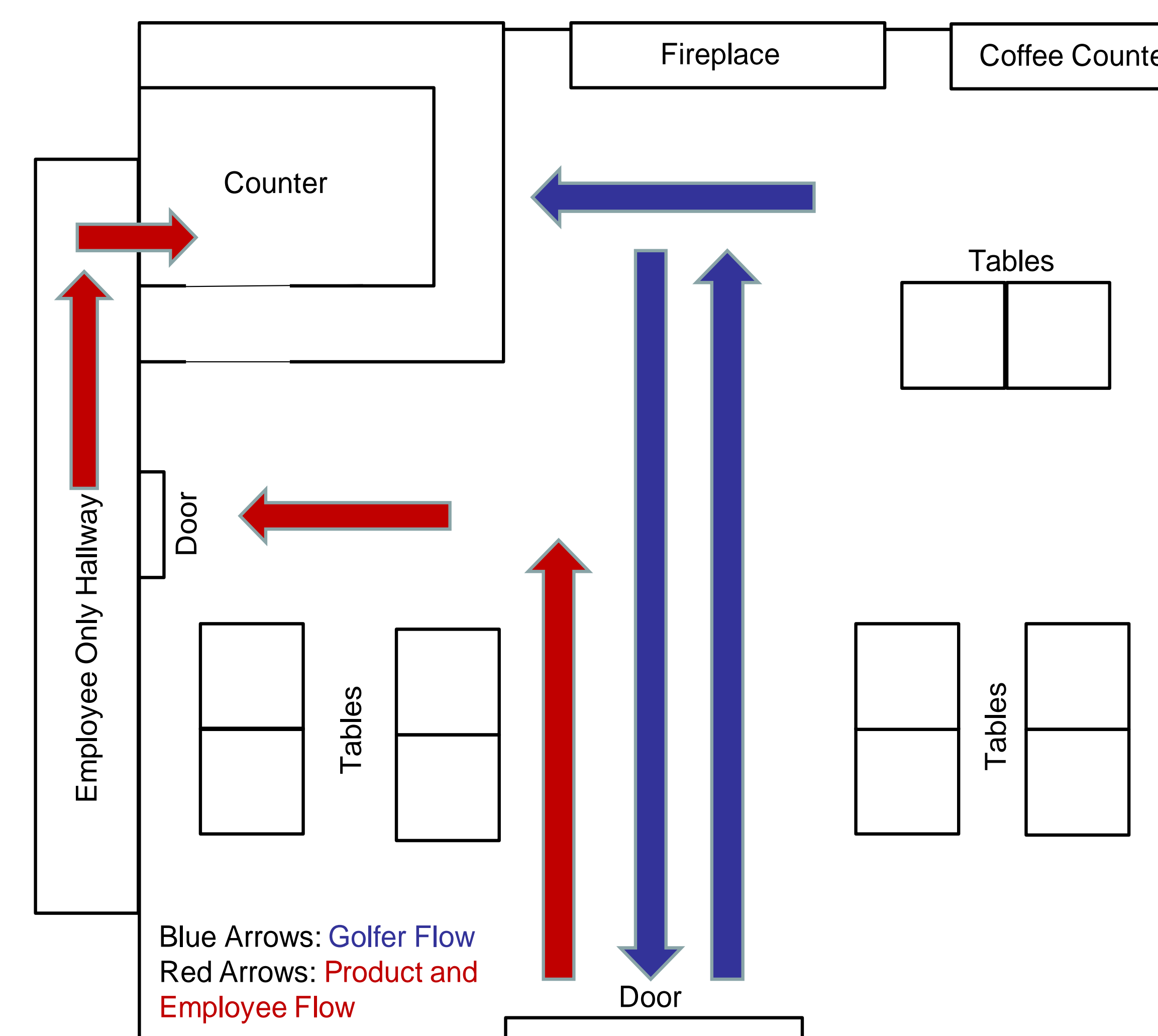

Proposed Solutions

- Provide quantifiable layout options for staff/patron interaction
- Include an open community area with private rental capability

Major Outcomes

- Maximize service efficiencies
- Minimize staff travel distance
- Maximize patron access to staff, restrooms, and services

Benefit to Client

- Maximize staff and patron interaction
- Maximize product flow
- Reduce check-in time
- Provide useful facility for all seasons

Additional Facility Improvements

- Indoor restrooms
- Community room
- Office area
- Storage area
- Larger facility

Proposed Layout

