

DE NU | TOMI LAJA & NICHOLAS NAGAWIECKI

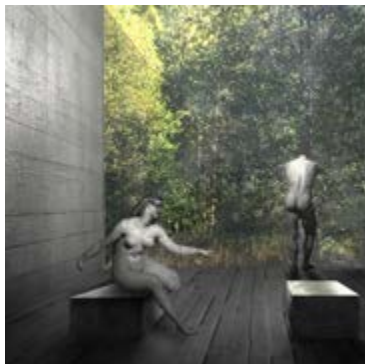

How does one create  
imagery that is honest yet  
evocative- intrigued and pure?

When the architecture is  
one with nature, its only  
valid to represent the  
experience entirely as that:  
natural.

Imagine a building:  
monolithic, cubed concrete  
sprinkled upon Latvian  
grassland.

Each room highlights  
forest, water, or sky-  
a knowing eye of the natural  
world forever present.

This space is separate yet  
one with nature:  
protective and transparent  
to beautiful earth.

Human interaction, scale,  
and activity is represented  
by taking the materiality  
of the architecture to  
create a living and active  
form within.

From the transparent  
glass to the humble oak  
trees, the marble  
sculptures create a  
dichotomy of presence-  
a here but away  
representation of the body.

She is yearning for  
something more, relaxed.  
And the figure closer to  
the barrier is curious, wise,  
longer aged.

The imperfect appearance  
of body adds to the  
honesty.

The beautiful landscaping of  
curves on both the  
figures present the human  
scale directly as  
transparent as the architecture.

Undisguised.  
Understated.

*t.o.l.*